

Ruffling Foot

Item No: B5002S07A (BLE8-RF)

Machine Settings:

Stitch Type: 4-Thread Overlock
 Needle: O1 and O2
 Upper Knife: Engaged "UNLOCKED"
 Stitch Selector: A

Stitch Width: M-7.5
 Stitch Length: 4
 Differential Feed: 2
 Sewing Speed: Slow to moderate

Gathering fabric:

Place fabric under the presser foot and sew. Generously feed fabric. The fabric will gather as you sew.

Shirring:

- Place fabric to be gathered right side up under the presser foot and under the separator.
- Position the fabric up to the needles. Turn handwheel 3-4 times to catch the fabric with the needles.
- Place the fabric to attach the gather to right side down on top of the separator (see illustration). This keeps the fabric away from the feed dogs.
- Place the fabric up to the needles. Turn the handwheel 3-4 turns to catch the fabric with the needles.
- Gently guide the upper fabric into the separator while generously guiding the lower fabric that is being gathered under the separator. The ruffle will be sewn to the flat fabric while sewing.

Note: Gathering works the best with fine fabrics. The heavier the fabric the less the gathering.

Fabric size

①..... bodice

②..... ruffle x 2

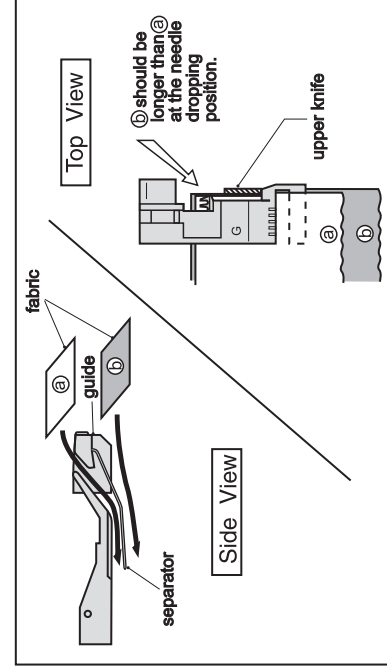

Available for:

BLETS8, BLETS8AE, BLES8, BLE8W-2, BLE8W, BLE8 series, BLE5 series

baby lock

Elastic Foot

Item No: B5002S09A (BLE8-EF)

Parts description

tension adjuster screw
 adjustable guide screw
 adjustable tape guide
 (for tape width:2mm-20mm)

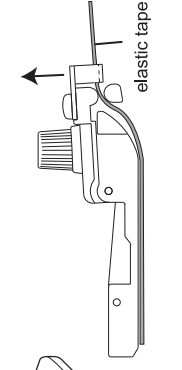

- Replace regular foot with special elastic foot.
- Slightly raise the elastic guide of the foot and insert elastic between elastic guide and lower support bar then position the elastic under the foot as illustrated, until the edge of the elastic reaches the feed teeth. (It may be necessary to loosen the tension adjuster screw to feed elastic through).
- Sew the elastic for about one inch or so to ensure it is feeding properly.
- Place the fabric under the foot and sew elastic to fabric.
- Check that the stitch formation is uniformly balanced and if necessary, adjust the thread tension controls.
- Adjust the tension adjuster screw so that the desired finish can be obtained.
 - Tighter tension of the tension adjuster screw (turning screw clockwise) gives more elasticity of the fabric after it is sewn.
 - Looser tension of the tension adjuster screw (turning screw counter-clockwise) gives less elasticity of the fabric.

① For Elastic Tape Insertion

OVERLOCK

Stitch Type: 4-Thread Overlock
 Needle: O1 and O2
 Stitch Selector: A
 Stitch Width: M
 Stitch Length: 4
 Differential Feed: N
 Upper Knife: Engaged "UNLOCKED"
 Sewing Speed: Slow

COVER STITCH

Stitch Type: Triple Cover Stitch or Wide Cover Stitch
 Needles: Triple Cover Stitch-C1,C2,C3
 Wide Cover Stitch-C1,C3
 Stitch Length: 4
 Stitch Width: M
 Differential Feed: N
 Upper Knife: Disengaged "LOCKED"
 Sewing Table: Remove knife cover and snap on the sewing table
 Sewing Speed: Slow

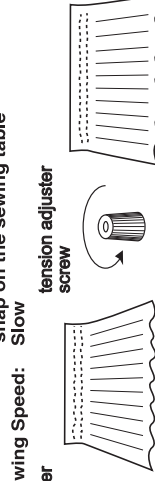
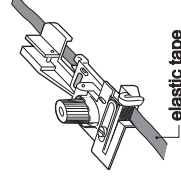

② For Fishing Line Insertion

Stitch Type: 3-Thread Rolled Hem
 Needle: O2
 Stitch Selector: D
 Stitch Width: 5.0

Stitch Length: 1.5R (Rolled hem setting)
 Differential Feed: 0.6
 Upper Knife: Engaged "Unlocked"
 Sewing Speed: Slow

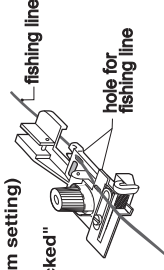

Beading Foot

Item No: B5002-04A-C (BLE8-BF)

(This foot is available for max. 4mm beads, sequins or ribbon and is available for right needle only)

① On Fabric Edge

Needle : O2
 Upper Knife : Engaged "UNLOCKED"
 Stitch Type : 3-Thread Rolled Hem
 Stitch Selector : D
 Stitch Width : M
 Stitch Length : 3-4 Rolled Hem
 Differential Feed : N-0.6

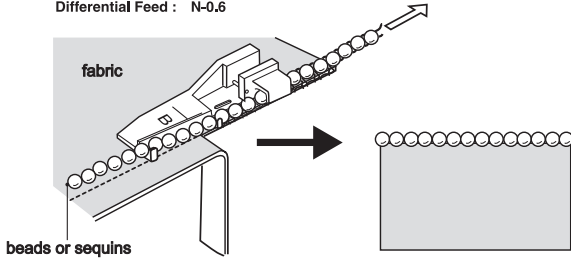

② Flatlock-On Fold

Needle : O2
 Upper Knife : Disengaged "LOCKED"
 Stitch Type : 2-Thread Narrow Hem
 Stitch Selector : B
 Stitch Width : M
 Stitch Length : 3-4
 Differential Feed : N-0.6

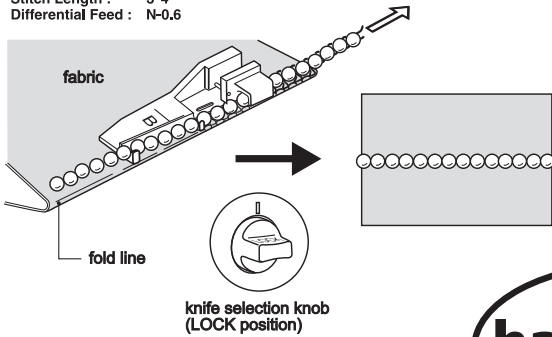

Piping / Cording Foot

"P5" = 5mm Cording Item No: B5002-05A-C (BLE8-CF)

PIPING IN SEAM

Machine Settings:
 Stitch Type: 4-Thread Overlock
 Needle: O1 and O2
 Upper Knife: Engaged "UNLOCKED"
 Stitch Selector: A
 Stitch Width: M-7.5
 Stitch Length: 3-3.5
 Differential Feed: N
 Sewing Speed: Slow to moderate speed

To make covered piping:

Fold bias strip of fabric right side out around the cording and place the cording under the presser foot into the cord guide. Guide the raw edges of the folded bias along the right edge of the needle plate using the knife to trim excess fabric.

To cover and attach piping/cording in fabric seam:

Fold bias strip of fabric right side out around the cording. Sandwich cording between 2 layers of fabric with right sides together.
 Place under the presser foot with raw edges to the right and the cording in the cord guide in the sole of the foot. Be sure to guide the cord in the guide while sewing.

PIPING IN FABRIC CENTER

Machine Settings:
 Stitch Type: 2-Thread Chain Stitch
 Needle: C2 (5mm), C3 (3mm)
 Upper Knife: Disengaged "LOCKED"
 Stitch Width: M
 Stitch Length: 3-3.5
 Differential Feed: N
 Sewing Speed: Slow to moderate speed

Fold fabric around cording with right side out. Place cording under the presser foot into the cord guide. Stitch C2 chain stitch, guiding the cord and fabric fold into the guide.

NOTE:

Try a 7-thread stitch for a completely different corded look.
 Use the C1 and C2 cover stitch settings combined with the 4-thread overlock settings. Place cording between 2 layers of fabric wrong sides together. The edge will finish with the 4-thread overlock while the left narrow cover stitch will sew on the left side of the cord.

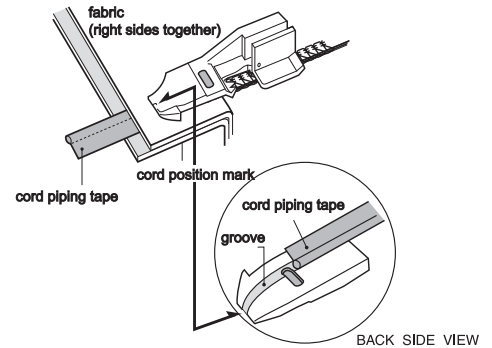

Blindhem Foot

Item No: B5002S06A (BLE8-BLHF)

- For hemming, fold fabric as shown in diagram.
- Place garment with wrong side up under the presser foot. Before you begin serging, check the needle dropping position. The needle should just catch the fold of the fabric.
- Once the needle dropping position has been determined, set the adjustable guide on the foot to the fold edge of the fabric. Move the adjustable guide by loosening the screw on top of the foot, adjusting the plate right or left and tighten the screw.

Needle : O2
 Upper Knife : Engaged "UNLOCKED"
 Stitch Type : 2-Thread Narrow Hem
 Stitch Selector : B
 Stitch Width : 5.0mm
 Stitch Length : 3.5
 Differential Feed : N

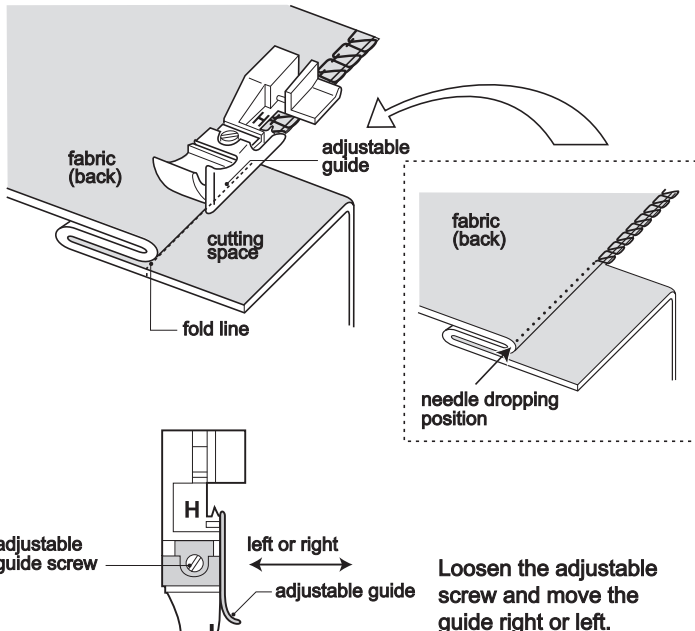

Lace Applicator Foot

Item No: B5002S08A (BLE8-LF)

Use this foot for guiding lace onto your fabric with a 2-thread flatlock. Or use the guide to attach ribbon to your fabric under a cover stitch. Or attach decorative trim by combine an overlock stitch with chain stitch. Follow your "Quick Reference Threading Guide" for various stitches and the settings.

- Loosen adjustable screw on the top of the foot.
- Raise the presser foot.
- Place fabric right side up under the foot up to the cutting blade.
- Insert lace right side down into the guide and under the foot against the right side.
- Align right edge of guide with placement of right edge of lace.
- Move the guide right or left and lower the presser foot.
- Check guide position and tighten the screw.

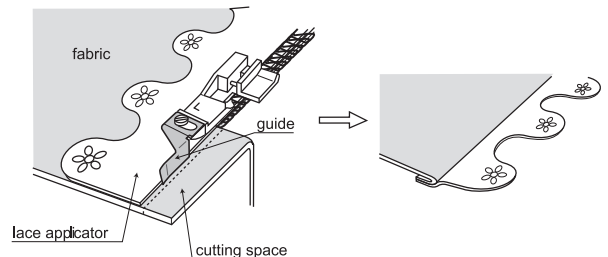

Adjustment of guide

